

CMHD2003
**HIGH VOLTAGE
SWITCHING DIODE**



SOD-123 CASE

CentralTM

Semiconductor Corp.

DESCRIPTION:

The CENTRAL SEMICONDUCTOR CMHD2003 is a Silicon Switching Diode, manufactured by the epitaxial planar process, epoxy molded in a SOD-123 surface mount package, designed for applications requiring high voltage capability. **Marking Code is C03.**

MAXIMUM RATINGS (T_A=25°C unless otherwise noted)

	<u>SYMBOL</u>		<u>UNITS</u>
Continuous Reverse Voltage	V _R	250	V
Continuous Forward Current	I _F	250	mA
Average Rectified Current	I _O	200	mA
Peak Repetitive Forward Current	I _{FRM}	625	mA
Forward Surge Current, t _p <1s, T _C =25°C	I _{FSM}	1.0	A
Power Dissipation	P _D	400	mW
Operating and Storage			
Junction Temperature	T _J , T _{stg}	-65 to +150	°C
Thermal Resistance	θ _{JA}	312.5	°C/W

ELECTRICAL CHARACTERISTICS (T_A=25°C unless otherwise noted)

<u>SYMBOL</u>	<u>TEST CONDITIONS</u>	<u>MIN</u>	<u>TYP</u>	<u>MAX</u>	<u>UNITS</u>
I _R	V _R =200V			100	nA
I _R	V _R =200V, T _C =100°C			15	μA
V _F	I _F =100mA			1.0	V
C _T	V _R =0, f=1 MHz		1.5		pF
t _{rr}	I _F =I _R =30mA, R _L =100Ω, Rec. to 3.0mA			50	ns

**HIGH VOLTAGE
SWITCHING DIODE**

MECHANICAL OUTLINE - SOD-123

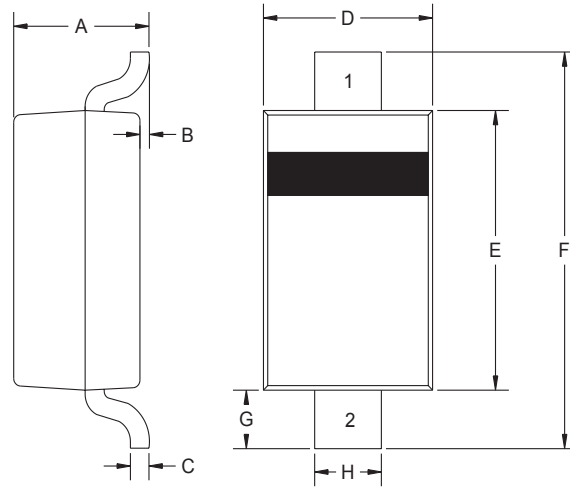

R3

SYMBOL	DIMENSIONS			
	INCHES		MILLIMETERS	
	MIN	MAX	MIN	MAX
A	0.037	0.053	0.95	1.35
B	-	0.005	-	0.12
C	-	0.008	-	0.20
D	0.055	0.071	1.40	1.80
E	0.098	0.112	2.50	2.84
F	0.140	0.154	3.55	3.90
G	0.010	-	0.25	-
H	0.020	0.028	0.50	0.70

SOD-123 (REV:R3)

Lead Code:

- 1) Cathode**
- 2) Anode**

Marking Code is C03.

R2 (2-November 2001)